

Vector Fast Frame Rechargeable Lightbox w/Battery

VFF-LB-BAT-1-ASM

Vector Fast Frame™ Rechargeable Light Box is an innovative, collapsible SEG light box that sets up in seconds. Designed for ultimate flexibility, this sleek and portable display system delivers brilliant illumination without the need for external power sources, making it ideal for trade shows, retail environments, and pop-up events. The lithium-ion battery provides up to 15 hours of runtime on a single charge. This sleek 3.35" wide frame holds seamless, easy-to-change silicone edge graphics (SEG), which are easily applied to the front and back. Graphics can be easily swapped out to deliver new messages so you can use the frame again and again! Vector Fast Frame Rechargeable Light Box is lightweight, portable, and requires no tools, so assembly is a breeze. It packs down small, making travel and storage simple.



We are continually improving and modifying our product range and reserve the right to vary the specifications without prior notice. All dimensions and weights quoted are approximate and we accept no responsibility for variance. E&OE. See Graphic Templates for graphic bleed specifications

features and benefits:

Features and benefits:

- Collapsible, rechargeable slim light box 3'W x 7'H x 3.35" D
- Battery-operated and rechargeable with up to 15 hours runtime
- Digital display shows real-time battery life
- Collapsible, slim light box - freestanding, white frame
- Assembles in seconds
- Seamless and easy to change SEG push-fit graphics
- Front and back graphics available
- Highly portable and breaks down easy
- Includes carry bag
- Five year LED light warranty
- One year limited warranty against manufacturer defects

dimensions:

Hardware

Assembled unit:

36" w x 75.5" h x 15.75" d
914mm w x 1918mm h x 400mm d

Approximate Weight: 24 lbs / 10.9 kg

Shipping

Packing case(s): 1 Box

Shipping dimensions:
44"L x 14.25"H x 11"D

Approximate shipping weight:
32bs / 14.5kg

Graphics

Graphic material:
Back-lit Textile (dye-sublimated fabric)

Refer to related graphic templates for more information Visit:

<https://www.theexhibitorshandbook.com/downloads/download-graphic-templates>
or click here

additional information:

SAVE ALL PACKAGING. THIS IS NEEDED FOR ALL RETURNS.

GROUND SHIPMENT ONLY FOR UNITS WITH BATTERY INSTALLED.

Battery:

Lithium-ion 2700mAh

Charging:

The battery can be charged in or out of the display. The display can be powered on during charging, however for maximum charging efficiency it is recommended that the display be powered off during charging.

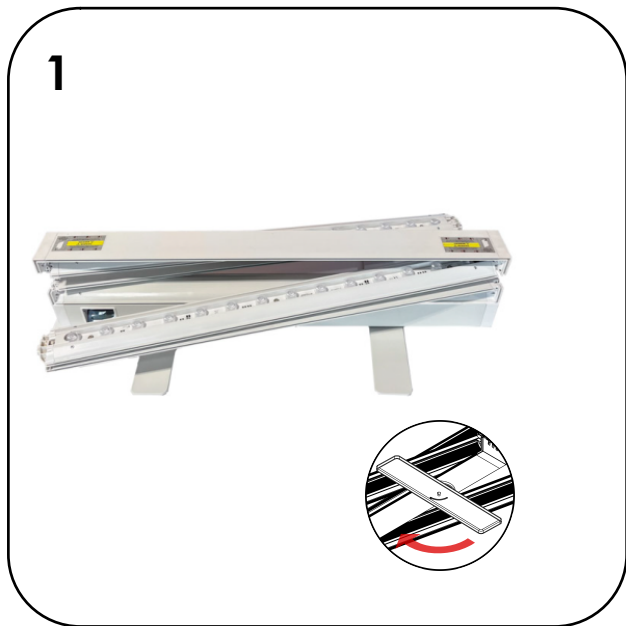

Lay frame on floor with feet and rotate the feet 90 degrees.

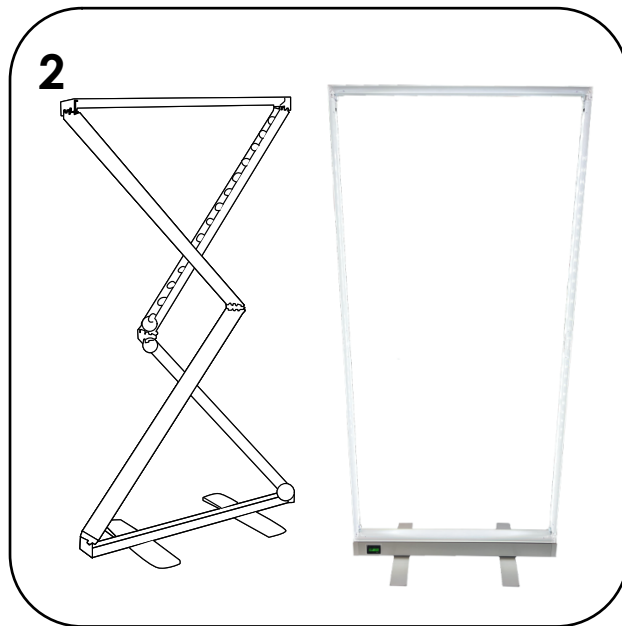

Unfold the frame by lifting the top.

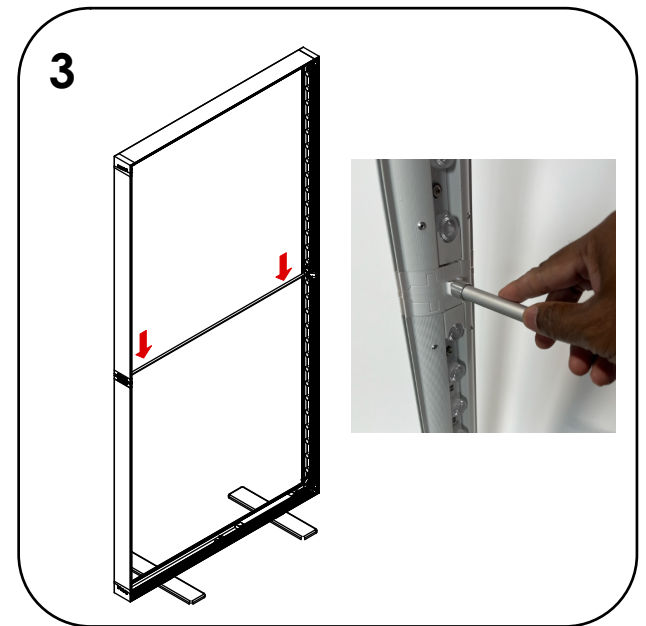

Press the horizontal support pole into place as shown.



Tilt the unit on its side opposite the digital display. Remove the two thumb screws to remove the battery tray.

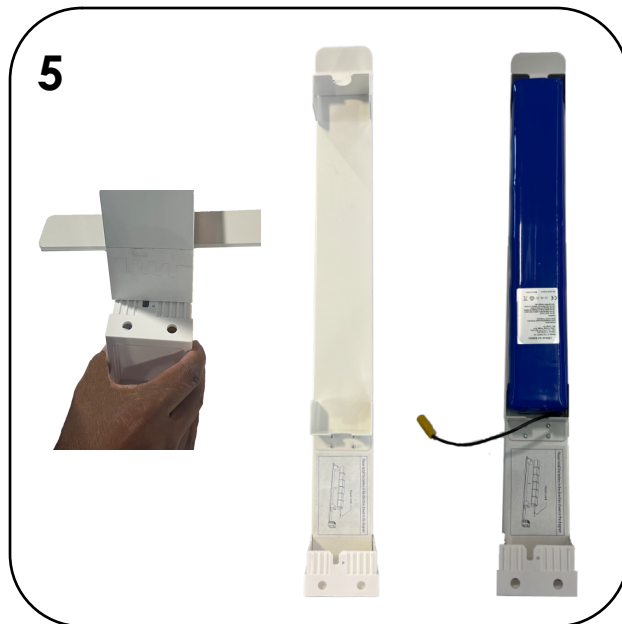

Pull the battery tray forward and remove from the frame. Install battery in the tray.

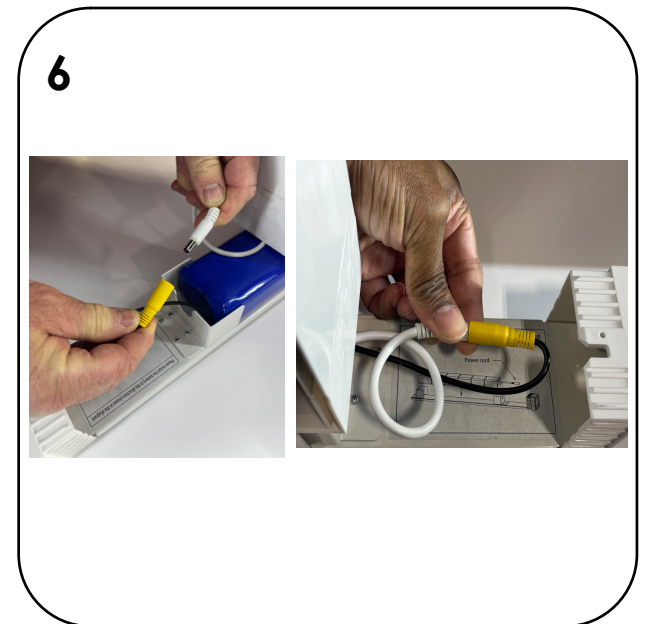

Connect the battery and place the cable in the front of the tray. Close tray and install thumb screws.

7



Charge the unit with the included power supply by connecting to the charging port on the side of the frame.

8

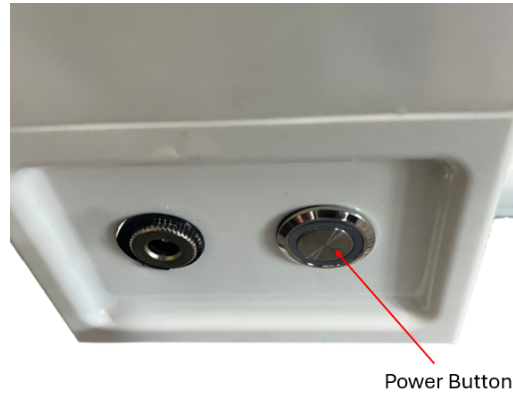

Turn the unit on/off with the power button on the side of the frame.

9

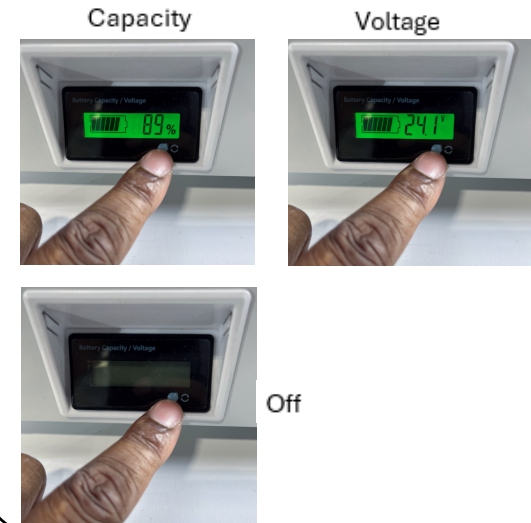

The display shows battery capacity and voltage. Press the button to cycle through the options.

10



Green light on the power supply indicates battery is fully charged

11

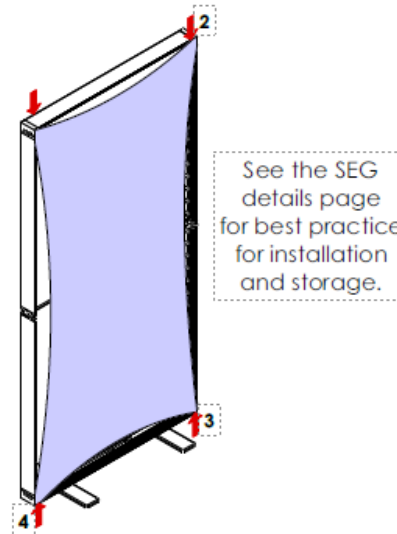

Install graphics

How to Apply & Remove Graphics

Installation and removal of SEG graphics is easy!

Installation: Push the SEG bead into each corner of the frame (1-4) with your thumb, then push the SEG bead into the middle of the run (5-8) and work your way around the perimeter of the frame until all beading is pushed in properly; if necessary, go around the perimeter again to ensure beading is secure in the extrusion profile.

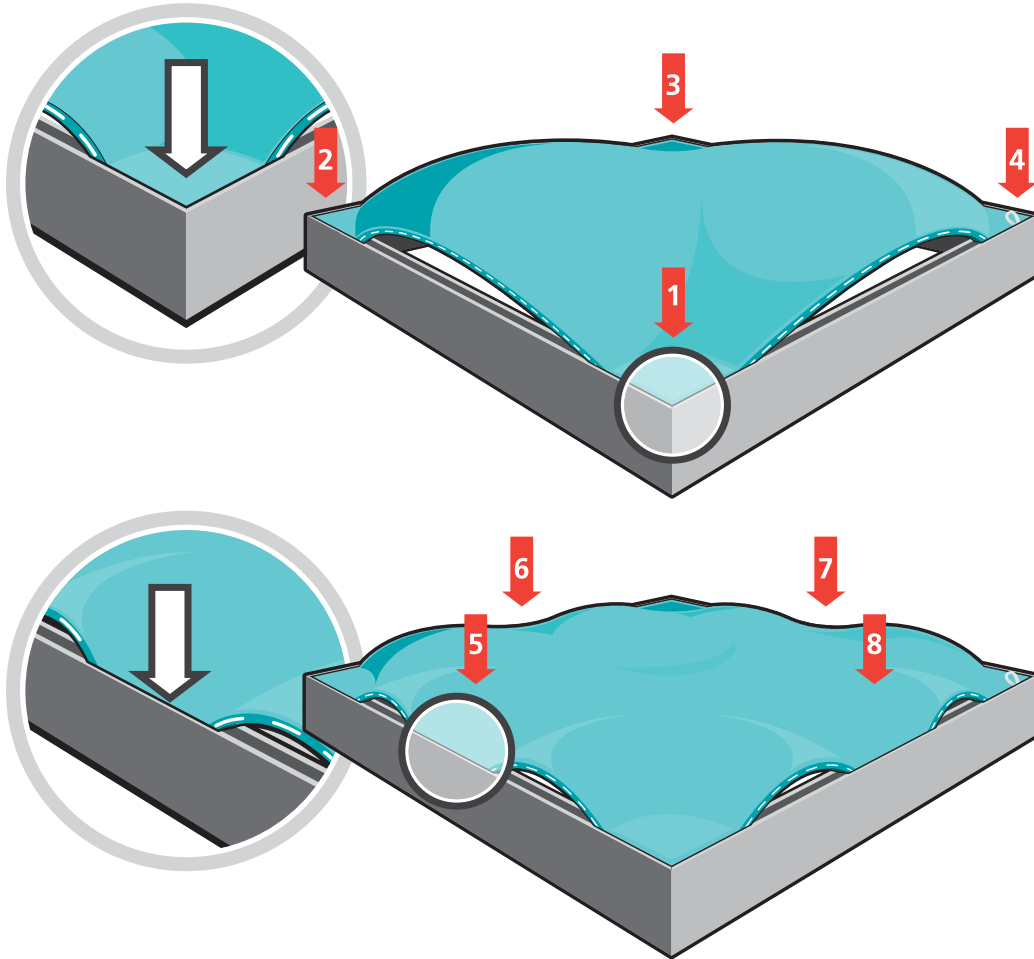

Note: Keep the set up area clean by using a drop cloth, washing hands before set-up or by wearing gloves.

Removal: Use the pull tab located on the graphic and gently pull the graphic from the frame, going around the perimeter.

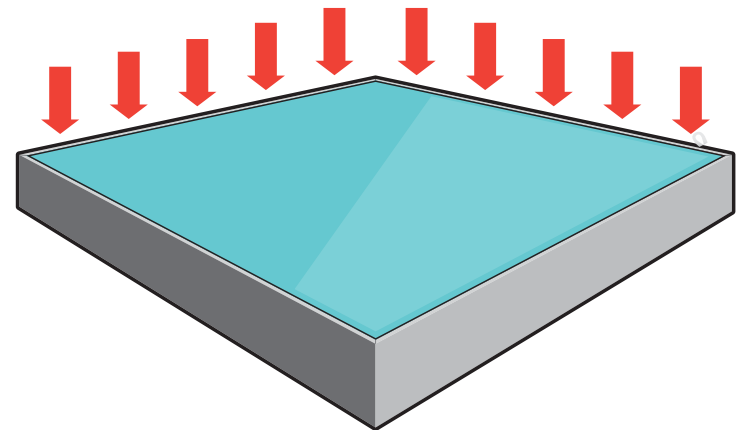

Graphics Storage & Care

Graphics should be folded with the graphic facing inward and stored in a zip lock /sealable plastic bag. Spot clean by wiping with a damp white cloth. If washing is necessary, use a commercial size front-loading washing machine, gentle cycle with cool water. Line dry flat. Dry cleaning is NOT recommended to prevent shrinkage.

Lithium-ion battery storage and usage instructions

1. Lithium-ion batteries should be stored in a cool, dry, and ventilated environment, away from sources of fire and high temperatures. The storage temperature of the battery must be within the range of $-10\text{ }^{\circ}\text{C}$ to $45\text{ }^{\circ}\text{C}$, with a humidity of $65 \pm 20\%$ RH.
2. Storage voltage and power: voltage range from 3.7V to 3.9V (4.2V standard voltage system); The battery level is between 30% and 85%
3. Long term storage batteries (over 5 months) must be placed in an environment with temperature of $23 \pm 5\text{ }^{\circ}\text{C}$ and a humidity of $65 \pm 20\%$ RH.
4. The battery should be stored according to storage requirements, fully charged and discharged once every 5 months, and recharged to 85% capacity.
5. Do not transport batteries when the ambient temperature is above $65\text{ }^{\circ}\text{C}$.
6. Only use the charger that came with the unit. Using high current or high voltage charging may cause issues with charging and discharging performance, and may lead to overheating, leakage, or bulging.
7. Light discharge is beneficial for improving its lifespan.
8. When the battery is low, it should be charged within 12 hours.
9. Do not use or store batteries near heat sources.
10. Do not pierce the battery casing with nails or other sharp objects.
11. Do not disassemble the battery.