

# Formulate Master 3D Hanging Structures: Capsule

## CAPSULE-18

Formulate® tension fabric hanging structures are made in the USA and are of the utmost quality and durability. Formulate combines state-of-the-art zipper pillowcase dye-sublimated stretch fabric coverings with advanced, lightweight aluminum structures to provide unique design, functionality, and style.



We are continually improving and modifying our product range and reserve the right to vary the specifications without prior notice. All dimensions and weights quoted are approximate and we accept no responsibility for variance. E&OE. See Graphic Templates for graphic bleed specifications.

## features and benefits:

- 10' shapes are constructed with 30mm (1.25") tubes and push button connectors for simple assembly.
- 14' shapes and over are constructed with 50mm (2") tubes and internal expanding spigot connectors for unmatched structural integrity
- Easy to store and ship
- Quick to set up
- One zipper pillowcase fabric graphic
- Lifetime limited hardware warranty against manufacturer defects

## dimensions:

Hardware

Assembled unit:

216"w x 96"h x 18"d

5486mm(w) x 2438mm(h) x 457mm(d)

Approximate weight:

116 lbs / 53 kgs

## Shipping

Packing case(s):

3 expandable cardboard boxes

Shipping dimensions:

Expandable cardboard box length (l) may vary

45-98"l x 16"h x 16"d

1143-2489mm(l) x 407mm(h) x 407mm(d)

Total shipping weight:

134 lbs / 61 kgs

## Graphic

Refer to related graphic template for more information.

Visit:

[www.exhibitors-handbook.com/graphic-templates](http://www.exhibitors-handbook.com/graphic-templates)

## additional information:

Graphic material:

dye-sublimation zipper pillowcase fabric

Power Strips / Extension Cords

Not Included

# Included In Your Kit

Tools, Components, & Connectors



ALLEN KEY SET x1



ES30 x8



ES50 x16



EYE BOLT 5/16"-18 x 3" x4

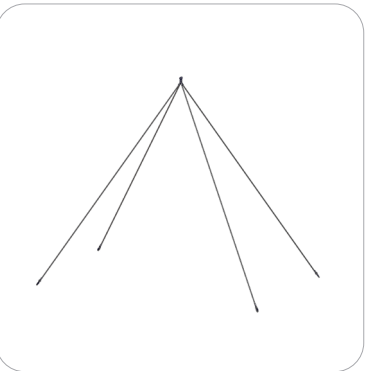

CH-SP4-HD-10 x1

Graphics



CAPSULE-18-G x1

# Included In Your Kit

Tubes & Extrusions



CAPSULE-18-T1 x4



CAPSULE-18-T2 x4

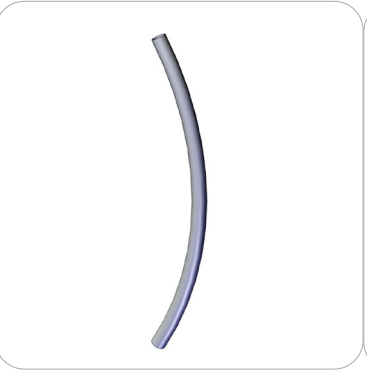

CAPSULE-18-T3 x4



CAPSULE-18-T4 x8



CAPSULE-18-T5 x8

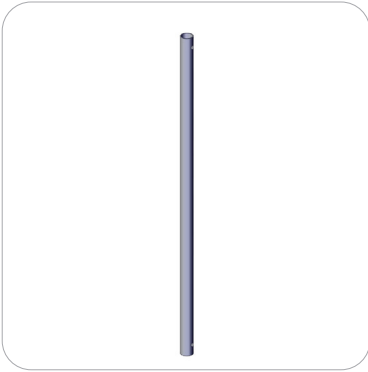

CAPSULE-18-T6 x4



CAPSULE-18-T7 x4

# Exploded View

## CAPSULE-18

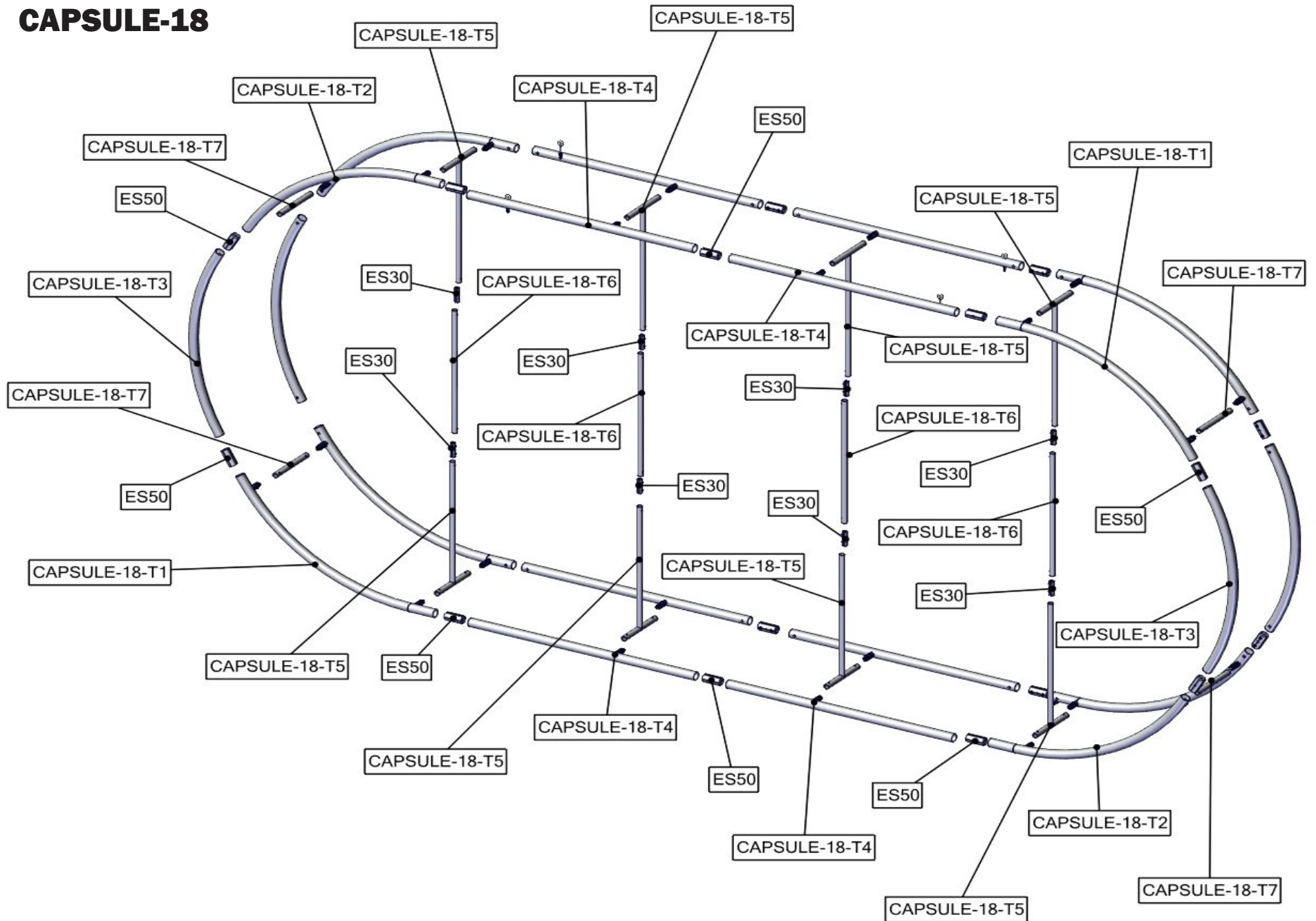

# Labeling Diagram

## CAPSULE-18

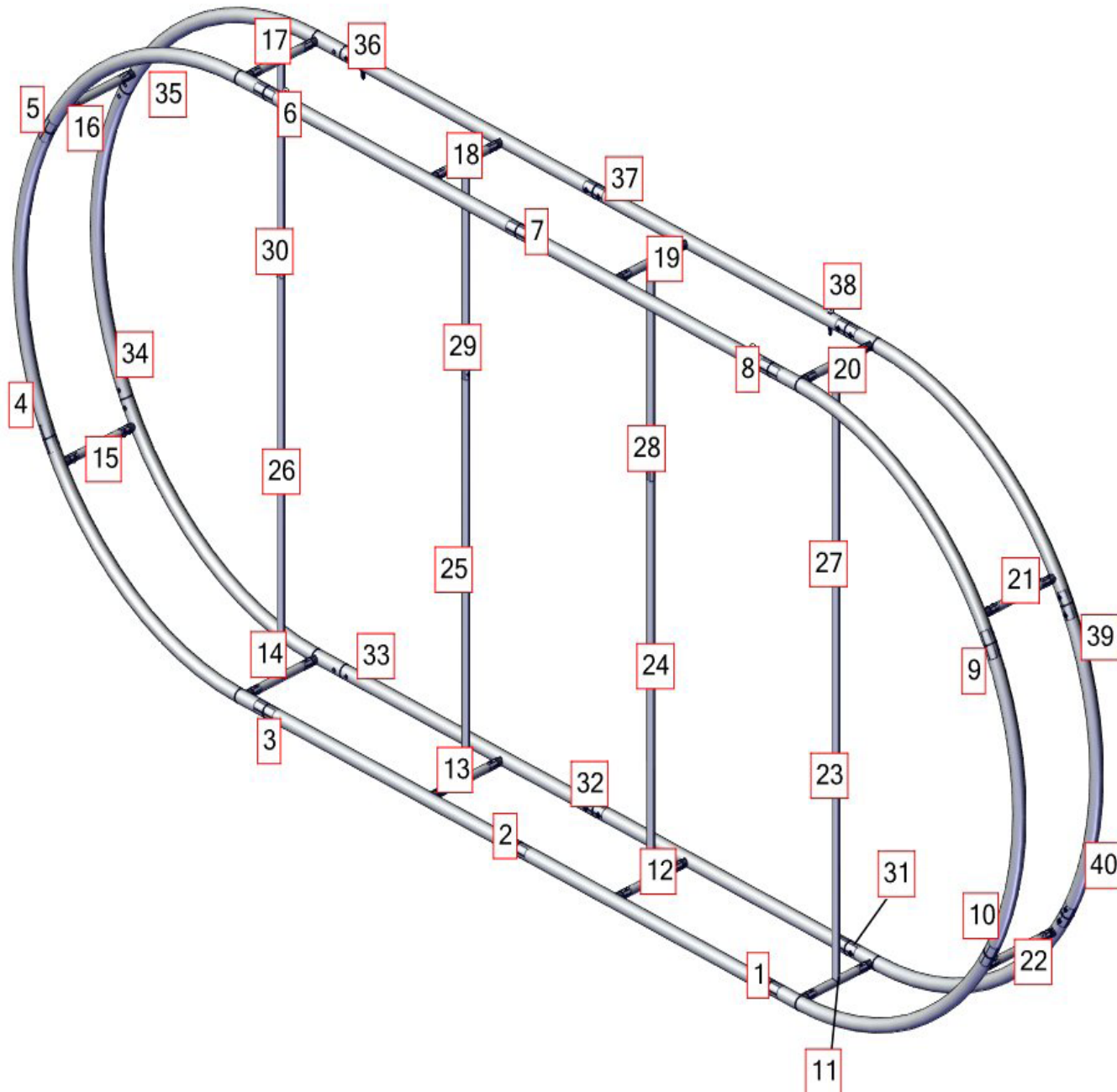

# Connection Methods

Formulate® structures use a number of different yet simple connection methods. Your kit will include one or more of the connection methods shown below. Steps within the Kit Assembly will reference a specific method for each connection point.

## Connection Method 1: ES30 / ES50 / ES75

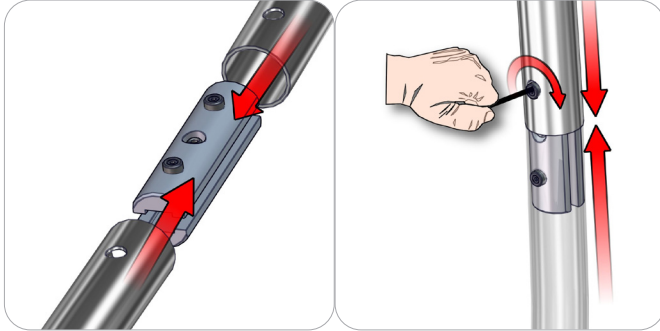

Compress the unlocked connector and slide one tube onto each end. Lock both screws carefully using your allen key tool. Be sure to lock securely, but do not over tighten.

## Connection Method 2: Snap Buttons & Swage

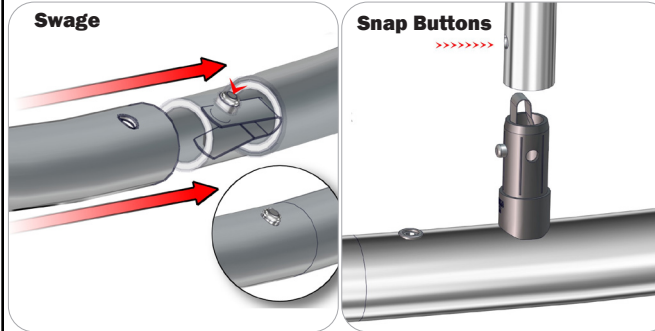

Locate the snap button on the connector or swage tube. Locate the hole on the corresponding tube. Press the snap button with your thumb and slide the tube and connector together so that the snap button snaps fully into the lock hole. To disassemble, press the snap button and pull apart.

## Connection Method 3: PE to Custom Aluminum Threaded Plate

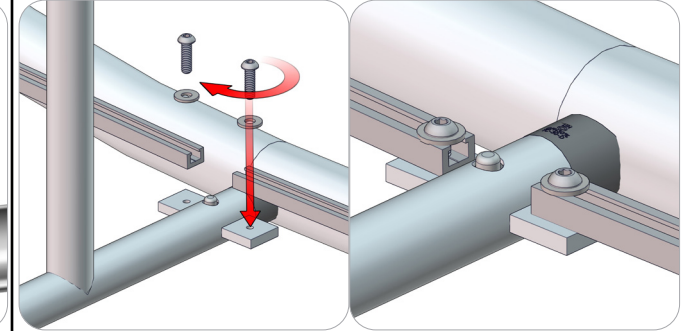

Hand fasten screws with washers carefully using your allen key tool. Be sure to fasten securely, but do not over tighten.

## Connection Method 4: Internal Lighting Setup

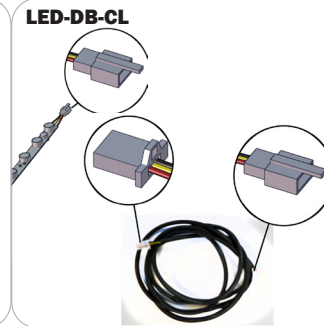
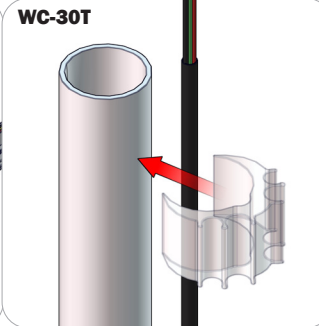
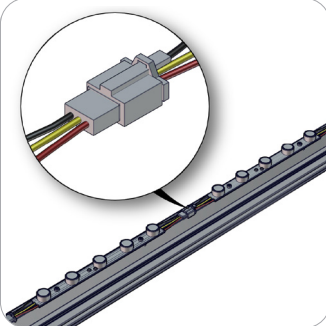
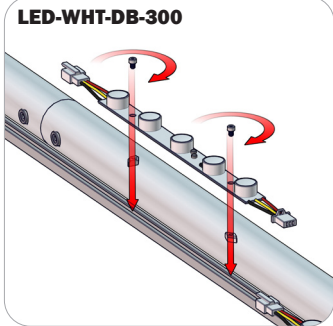

Be sure to fully assemble all frames before using the internal lighting components. With the thumbscrews loosened, place the light strips on the frame, then hand tighten them in series, male to female connections with extension cords. Do not over tighten the thumbscrews. Snap on the wire management clamps and extrusions with the power cord extensions in place. Reference the Internal Lighting Diagram for more details.



# Kit Assembly

## Step by Step

### Step 1.

Gather the tube and spigot components to build Frame A. Using the provided ALLEN KEY SET, hand tighten the spigots. Assemble in the order as the Exploded View and Labeling Diagram pages instructs.

Refer to Connection Methods 1 and 2 for additional information.

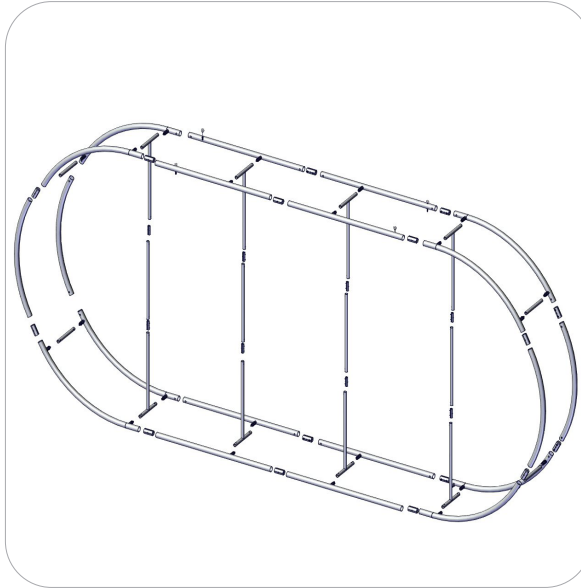
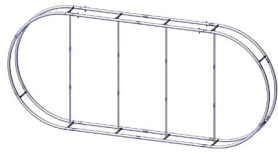

### Step 2.

Locate the two part graphic pillowcase. With the pillowcase unzipped, encase the frame from the bottom to the top. Zip the pillowcase fabric closed at the top.

Setup is complete and ready to hang.

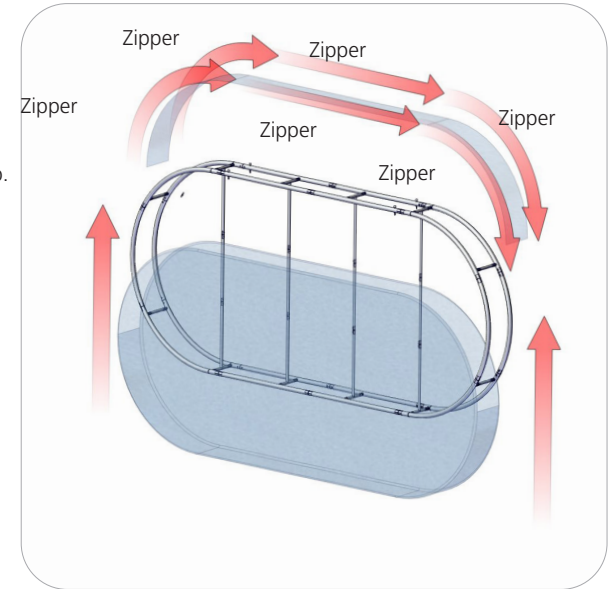
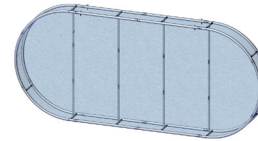

### Step 1.

Locate the two part graphic pillowcase. With the pillowcase unzipped, encase the frame from the bottom to the top. Zip the pillowcase fabric closed at the top.

Setup is complete and ready to hang.

